

# SI Stangkop

## EF12-20-502-DURBAL - EF12-20-502-DURBAL

<https://www.123kogellager.nl/kogellager-behuizing/stangkop/si/ef12-20-502-durbal>

EF12-20-502



rod end housing:  
forged steel, tempered, surface galvanized, free of Cr VI

joint ball:  
ball bearing steel, hardened and ground, surface superfinished and chromium plated

race:  
nylon / teflon / glass fibre compound

tolerances:  
see page 10

**DURBAL® heavy-duty rod ends with integral spherical plain bearing**

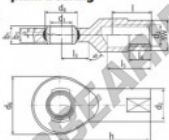

female thread:  
maintenance free, adapter sizes according to DIN ISO 12240-4, series E / EH



| order number      |                   | measurements [mm] |                |                   |                |                             |                             |                |                |                |                |                |                |                |                |                |                |   |
|-------------------|-------------------|-------------------|----------------|-------------------|----------------|-----------------------------|-----------------------------|----------------|----------------|----------------|----------------|----------------|----------------|----------------|----------------|----------------|----------------|---|
| type              | right-hand thread | d <sub>1</sub>    | d <sub>2</sub> | d <sub>3</sub>    | d <sub>4</sub> | d <sub>5</sub>              | d <sub>6</sub>              | d <sub>7</sub> | d <sub>8</sub> | b <sub>1</sub> | b <sub>2</sub> | b <sub>3</sub> | b <sub>4</sub> | b <sub>5</sub> | b <sub>6</sub> | b <sub>7</sub> | b <sub>8</sub> | h |
| EF 12             | -20               | -502              | 12             | 19                | M 12           | 32                          | 18,0                        | 10             | 7              | 50             |                |                |                |                |                |                |                |   |
| measurements [mm] |                   | weight            |                | basic load rating |                |                             |                             |                |                |                |                |                |                |                |                |                |                |   |
| type              | l                 | l <sub>3</sub>    | l <sub>4</sub> | l <sub>5</sub>    | SW             | α <sub>1</sub> <sup>1</sup> | α <sub>2</sub> <sup>1</sup> | kg             | C              | C <sub>0</sub> | stat.          | stat.          |                |                |                |                |                |   |
| EF 12             | 22                | 15                |                |                   | 17             | 10,5                        | 5,0                         | 0,086          | 9200           | 28000          |                |                |                |                |                |                |                |   |

## PRODUCTKENMERKEN

|                |               |
|----------------|---------------|
| Merk           | DURBAL        |
| N° Ean13       | 3663952508399 |
| Binnendiameter | 12 mm         |
| Binnendiameter | 0.472" inch   |
| Buitendiameter | 32 mm         |
| Buitendiameter | 1.26" inch    |
| Dikte          | 10 mm         |
| Dikte          | 0.394" inch   |
| Type           | SI            |
| Gewicht        | 86 g          |
| Draad          | Linkse draad  |
| Smering        | zonder        |
| Verpakking     | 1             |

[contact@123kogellager.nl](mailto:contact@123kogellager.nl)

CRT4 de Lesquin 60 Rue Du Haut De Sainghin 59273 Fretin FRANCE