

GEEW Stangkop DGE15-FW-2RS-DURBAL - DGE15-FW-2RS-DURBAL

<https://www.123kogellager.nl/kogellager-behuizing/stangkop/geew/dge15-fw-2rs-durbal>

DGE15-FW-2RS



Description: spherical plain bearing with sliding combination steel / bronze-PTFE composite. Outer ring with two seals.

spherical plain bearing; maintenance free, according to DIN ISO 12240-1, series G

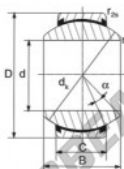

Sliding combination: steel / bronze-PTFE composite

Inner ring: bearing steel, hardened, ground and spherical surface chromium plated

Outer ring: bearing steel, hardened, ground, single split in axial direction; outer race lined with bronze-PTFE composite, lip seals on both sides

Lubrication: maintenance free

order number type	measurement [mm]			load rating C ₀ [kN]	weight [g]	
	D	d	B			
DGE 15 FW-2RS	15	16	10			
type	r _{1s} min	r _{2s} min	D	d ₁	α [°]	weight [g]
DGE 15 FW-2RS	0,3	0,3	30	25,0	16	0,046

PRODUCTKENMERKEN

Merk	DURBAL
N° Ean13	3663952502816
Binnendiameter	15 mm
Buitendiameter	30 mm
Dikte	10 mm
Type	GEEW
Gewicht	46 g
Smering	zonder
Verpakking	1

contact@123kogellager.nl

CRT4 de Lesquin 60 Rue Du Haut De Sainghin 59273 Fretin FRANCE